



10 Chester Road

Wheatley, Doncaster, DN2 4HH

Asking Price £125,000

Ideally located close to local amenities and offered for sale with no onward chain is this well presented three bedroom end terrace house. The property in brief comprises; entrance hallway, lounge, kitchen/dining room, cloak/wc, utility room, three good sized bedrooms and family bathroom. Outside; front and rear gardens, driveway providing off road parking thereafter leading to a detached garage. A deceptively spacious property situated close to the town centre and Doncaster Royal Infirmary, early viewing is highly recommended.

- End terrace house
- Three bedrooms
- Modern kitchen/diner
- Utility room and WC
- Family bathroom with white suite
- Off road parking and detached garage
- Close to town centre
- Well presented throughout
- No chain
- Viewing is a must

Viewing

Please contact our Office on 01302 751616 if you wish to arrange a viewing appointment for this property or require further information.



Floor Plan

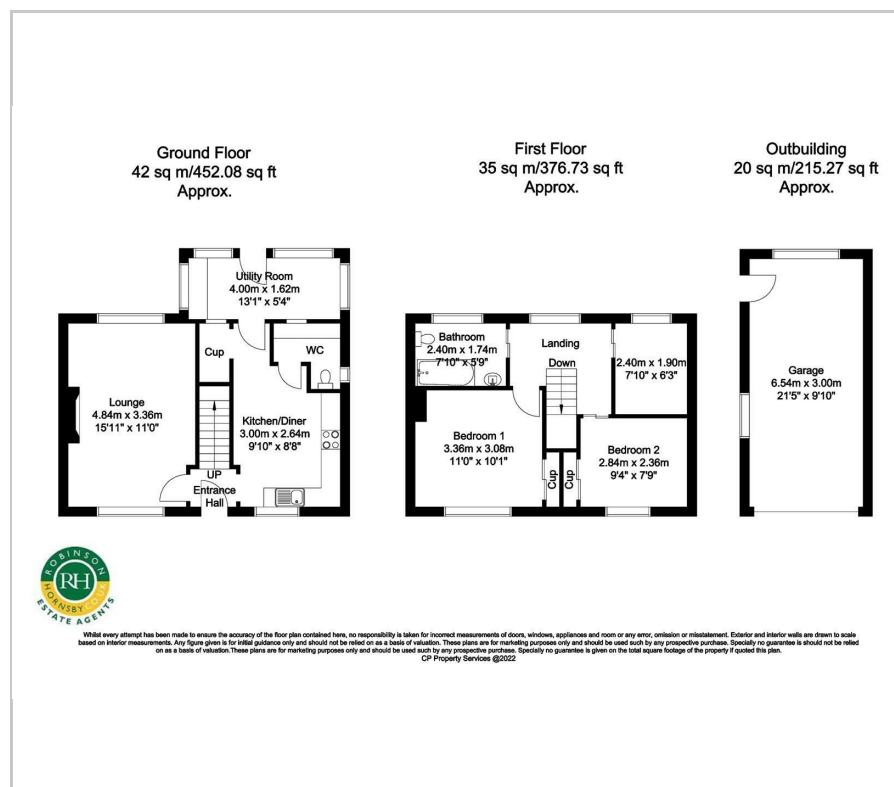

Area Map



Energy Efficiency Graph

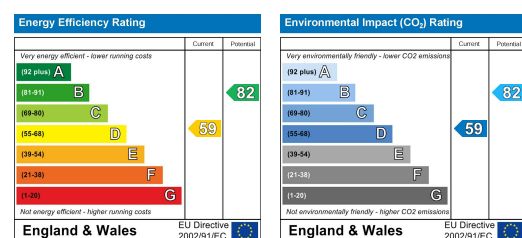

These particulars, whilst believed to be accurate are set out as a general outline only for guidance and do not constitute any part of an offer or contract. Intending purchasers should not rely on them as statements of representation of fact, but must satisfy themselves by inspection or otherwise as to their accuracy. No person in this firm's employment has the authority to make or give any representation or warranty in respect of the property.